

# MOUNTING KIT X-FUTURE

## KIT MONTAGGIO PARAMANI X-FUTURE



COD. 500007753 REV.2

### ACERBIS PARTS



AL - 1 pcs



AR - 1 pcs



B - 4 pcs

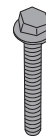

C - 2 pcs



D - 2 pcs

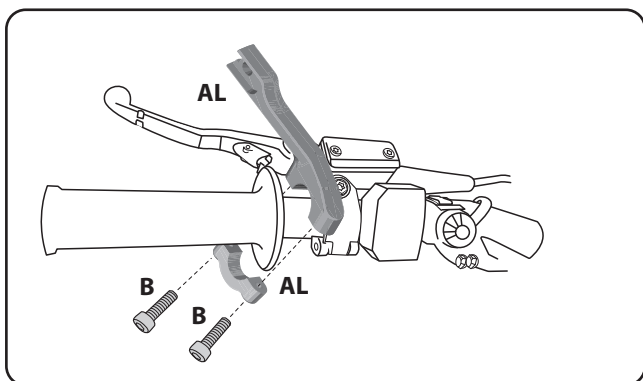

**1- Attach the Left side mount (AL) to the handlebar using the screws (B).**

1- Assemblare il bracciale sinistro (AL) al manubrio attraverso le viti (B).

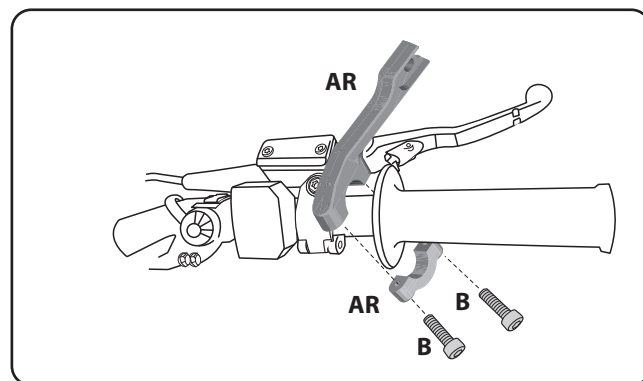

**1- Repeat the process with the Right side mount (AR). The mounts should extend over the top of the levers.**

1- Ripetere il processo con il bracciale destro (AR).

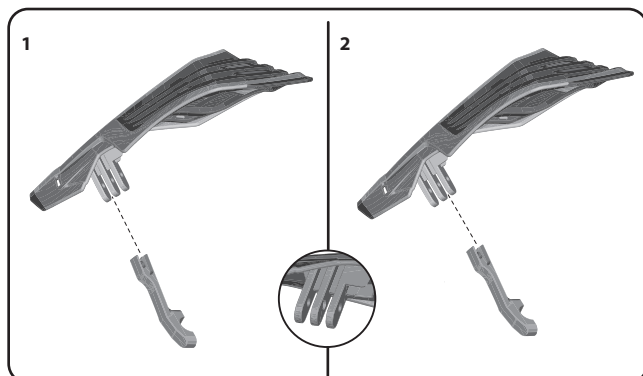

**2- Depending on your mounting location on the bars, attach the shields to the mounts utilizing the internal or external mounting points.**

2- Scegliere dove posizionare il paramano:  
posizione 1 - paramano più esterno  
posizione 2 - paramano più interno

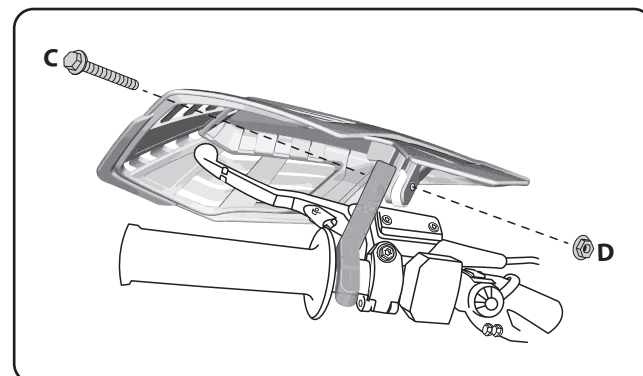

**3- Insert and tighten the screw (C) and the nut (D) to attach the shields to the mount. Check the bolts (B) on the mount to ensure they are also tight.**

3- Fissare il paramano al bracciale attraverso vite (C) e dado (D). Controllare che le viti (B) siano completamente avvitate.

### WARNING!

Follow mounting instruction exactly. Ensure that the mounting is secure before riding. These handguards will not prevent injury in the event of a crash. They are designed to protect the hands from cold weather. Be sure that you follow the instruction for installing the handguards. Do not ride with a broken tie wrap. Check to be sure the throttle and other controls are free every time you ride. Failure to heed instruction and this warning could lead to interference with the controls, loss of control of the motorcycle, and an accident.